



## Wall: Solid construction

### *Windtight and rainproof on the outside*

#### Joining window to solid wall construction



- Window installed on the outside surface



- Suggestion: Mount a wedge for better water discharge  $\geq 5^\circ$ . Observe the manufacturer's specification



- Bond the narrow side to the edge at the frame bottom
- Projecting on both sides
- Remove backing strip and press on firmly
- Cut into the excess, bisecting the angle, and press on



- Bond the narrow side to the lateral edge of the frame
- Projecting on both sides
- Remove backing strip and press on firmly

## Wall: Solid construction Windtight and rainproof on the outside

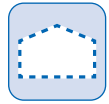

- Bond the narrow side to the top edge of the frame
- Projecting on both sides
- Remove backing strip and press on firmly
- Cut into the excess, bisecting the angle, and press on



### How it should look:

- Window installed on the outside surface joined

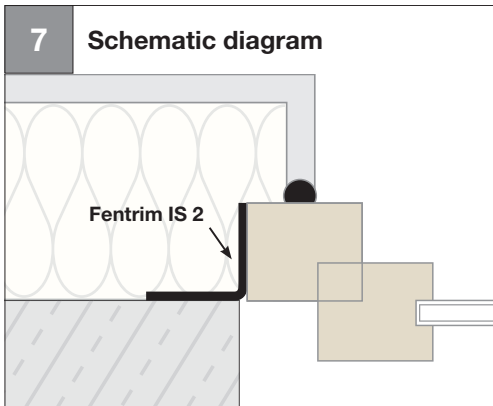

Window installed on the outside surface sealed airtight with Fentrim IS 2



**Fentrim**® IS 2

P. 147



## Wall: Solid construction

### *Windtight and rainproof on the outside*

#### Joining window to solid wall construction

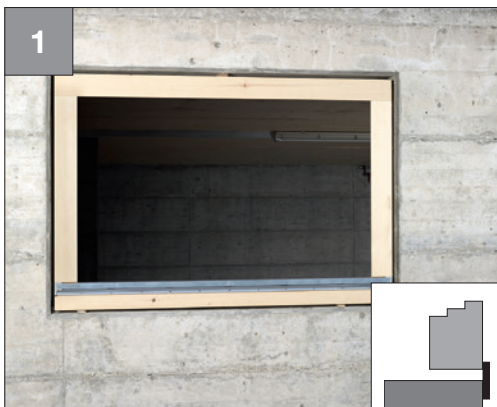

- Window installed flush with the outside surface



- Bond with the small side to the frame flush with the frame bottom edge
- Projecting about 10 cm on both sides
- Press on firmly



- Remove protruding backing strip step by step
- Align and fix free from tension

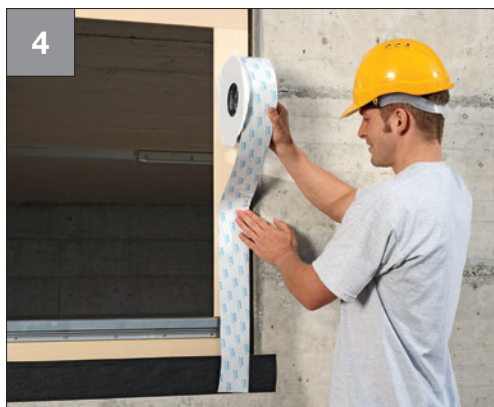

- Repeat on all sides

# Wall: Solid construction

## Windtight and rainproof on the outside



### How it should look:

- Window joined outside



### Thereafter:

- Cover connection with insulation

### Joint plastered:



**Fentrim**® 2

P. 145

### Joint covered:



**Fentrim**® IS 2

P. 147



## Wall: Solid construction *Windtight and rainproof on the outside*

### Joining window to solid wall construction

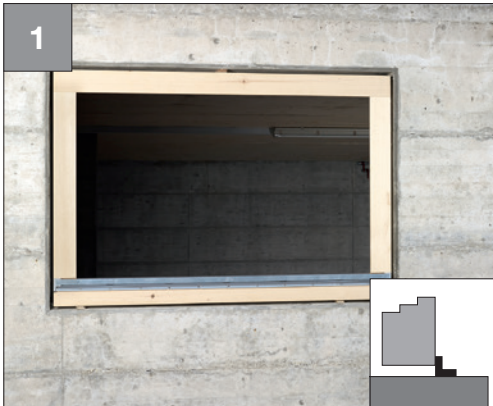

- Window installed centrally



- Bond the narrow side to the edge at the frame bottom
- Projecting by joint width + approx. 6 cm on both sides; form trough
- Press on firmly
- Cut off



- Remove protruding backing strip
- Align and fix free from tension
- Remove second backing strip
- Press on firmly



- Bond laterally to the frame
- Bond laterally to the reveal

# Wall: Solid construction

## Windtight and rainproof on the outside

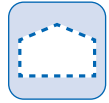

- Repeat on all sides



### How it should look:

- Window joined outside

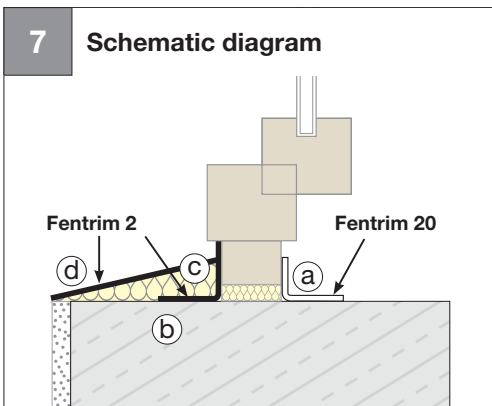

- Align airtight connection (a) with Fentrim 20 / Fentrim IS 20 vapour control layers
- Windtight connection resistant to driving rain (b) with Fentrim 2 / Fentrim IS 2
- Slope wedge (c) with an angle of  $\geq 5^\circ$
- Second water-bearing layer (d) with Fentrim IS 2

### Joint plastered:



### Fentrim® 2

P. 145

### Joint covered:

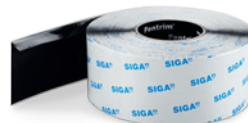

### Fentrim® IS 2

P. 147